



21 Walnut Crescent  
Kingswood, Bristol, BS15 4HX

**Asking price £320,000**



# 21 Walnut Crescent



## Description

Extended 1950's end terrace home located in Kingswood within easy reach of both Kingschase shopping centre and Longwell Green retail park. This lovely home has had one owner since new and enjoys the benefit of a corner plot with lovely views. Comprising a lounge with bay window opening up into the dining space and a further reception room overlooking the garden and access to a downstairs shower room. There's a modern kitchen breakfast room as well as a separate utility. Upstairs are three bedrooms, two doubles and single along with a bathroom.

Outside to the rear is an enclosed garden with lawn and shrub borders and side access leading to the detached garage. A fantastic home with plenty of scope to update to your own style. No Chain. South Gloucestershire Council. Band C

- EXTENDED 1950's
- 2ND RECEPTION
- UTILITY ROOM
- THREE BEDROOMS
- GARAGE
- LOUNGE DINER
- MODERN KITCHEN
- SHOWER ROOM
- UPSTAIRS BATHROOM
- NO CHAIN





## Floor Plan

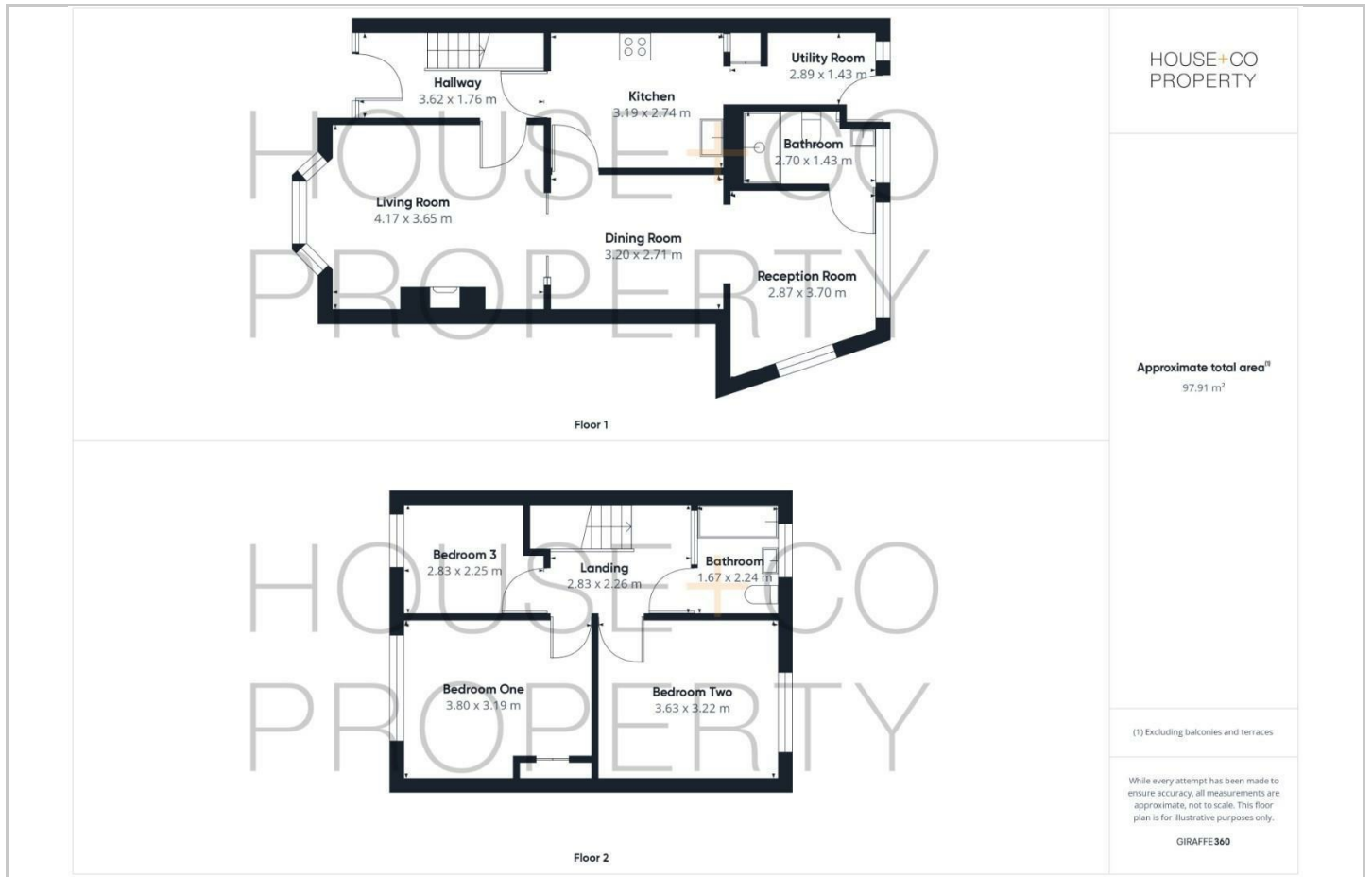

## Area Map

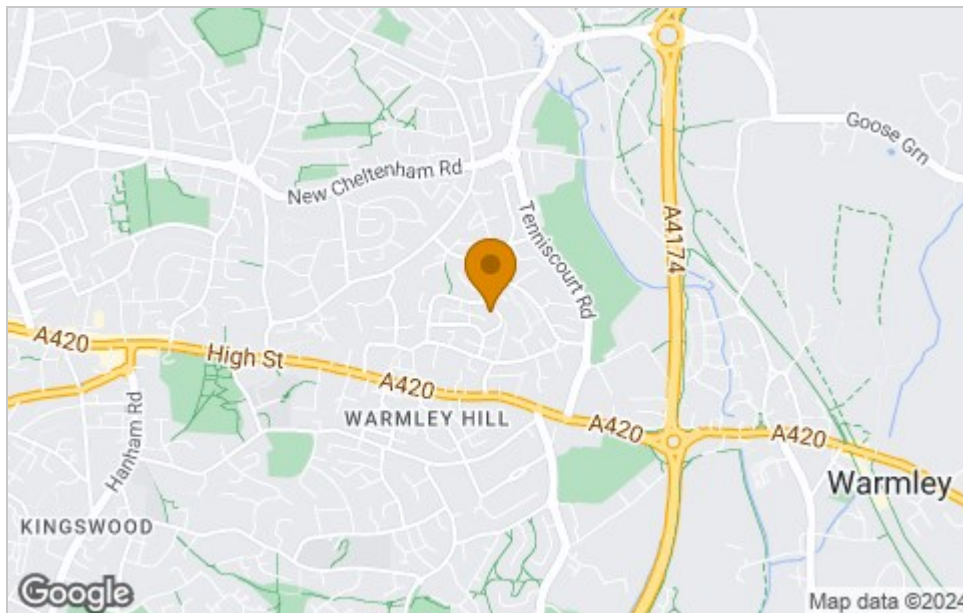

## Viewing

Please contact our House + Co Property (Sales) Office on 0117 907 0020 if you wish to arrange a viewing appointment for this property or require further information.

## Energy Efficiency Graph

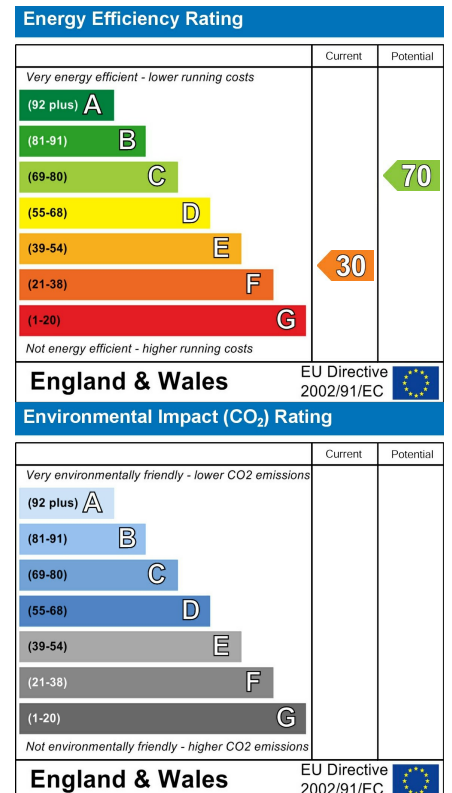

These particulars, whilst believed to be accurate are set out as a general outline only for guidance and do not constitute any part of an offer or contract. Intending purchasers should not rely on them as statements of representation of fact, but must satisfy themselves by inspection or otherwise as to their accuracy. No person in this firm's employment has the authority to make or give any representation or warranty in respect of the property.